

THIRD FLOOR PLAN AS EXISTING

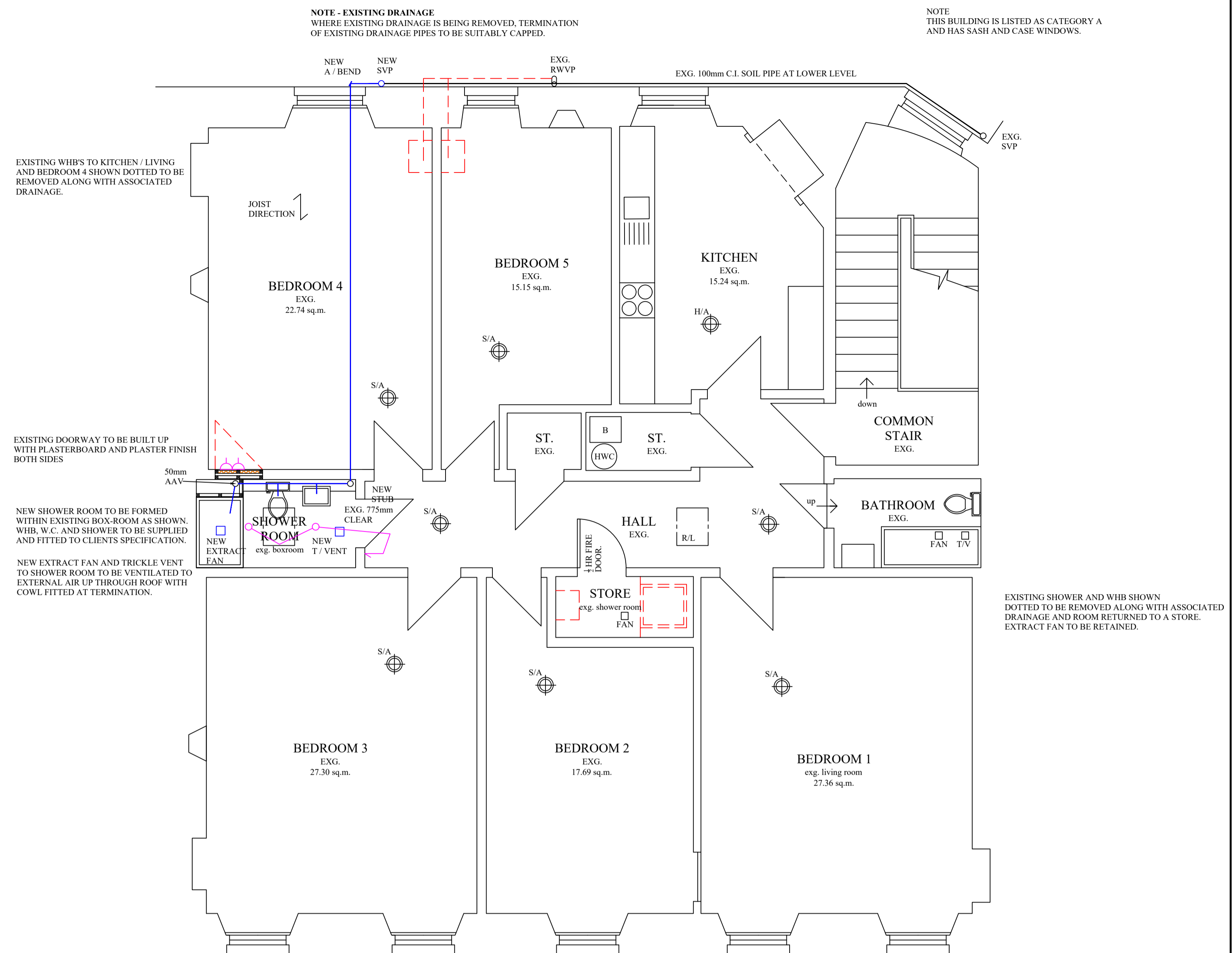

THIRD FLOOR PLAN AS PROPOSED

GENERAL NOTES:
 ALL NEW WORK TO BE CARRIED OUT AS PER THE CURRENT BUILDING (SCOTLAND) REGULATIONS AND MANUFACTURERS RECOMMENDATIONS.
 ALL WORK SHOWN RED AND DOTTED TO BE REMOVED.
 WHERE WORK HAS BEEN REMOVED ALL FINISHES ARE TO BE MADE GOOD.
 ALL ELECTRICAL WORK TO COMPLY WITH CHAPTER SAFETY SCOTTISH BUILDING STANDARDS, B.S. 7671 : 2008 AND THE CURRENT EDITION OF THE I.E.E. REGS.
 ELECTRIC SOCKET OUTLETS, BT, SKY, DATA POINTS ETC TO BE A MINIMUM OF 350mm FROM INTERNAL CORNERS, 400mm FROM THE FLOOR LEVEL AND AT LEAST 150mm ABOVE WORKTOPS.
 LIGHT SWITCHES TO BE FITTED BETWEEN 900mm & 1100mm ABOVE F.F.L.
 TRVS TO BE FITTED TO ALL NEW RADIATORS.

EVERY DEVICE, FITTING OR PIECE OF EQUIPMENT PROVIDED SO AS TO SERVE A PURPOSE OF THE REGULATIONS SHOULD BE DESIGNED, INSTALLED AND COMMISSIONED IN SUCH A WAY AS TO FULFILL THOSE PURPOSES.

CIRCUITS DESIGNED TO OPERATE AT OR BELOW LOW VOLTAGES (50 VOLTS AC OR 120 VOLTS DC) SHOULD BE PROTECTED AGAINST DIRECT OR INDIRECT CONTACT WITH ANY OTHER CIRCUIT OPERATING HIGHER THAN EXTRA - LOW VOLTAGE.

HEATING SYSTEM TO BE PROVIDED WITH THERMOSTATIC CONTROL VALVES TO RADIATORS, PIPEWORK TO BE INSULATED IN ACCORDANCE WITH THE GUIDANCE CONTAINED IN THE BRE REPORT REF 262: THERMAL INSULATION, AVOIDING RISKS (2002 EDITION) AND BS 5422 : 2009.

A MINIMUM OF 75% OF THE FIXED LIGHT FITTINGS AND LAMPS INSTALLED IN THE EXTENSIONS REQUIRE TO BE OF THE LOW ENERGY TYPE. THESE FITTINGS MAY BE EITHER DEDICATED FITTINGS WHICH WILL HAVE A SEPARATE CONTROL GEAR AND WILL ONLY TAKE LOW ENERGY LAMPS OR STANDARD FITTINGS SUPPLIED WITH LOW ENERGY LAMPS WITH INTEGRATED CONTROL GEAR (BAYONET OR EDISON SCREW BASE LAMPS).

NO WORKS ARE TO IMPAIR THE SOUND / FIRE RESISTANCE OF AN EXISTING SOUND / FIRE RESISTANT ELEMENT. ANY DISTURBED SOUND / FIRE RESISTANT ELEMENTS ARE TO BE MADE GOOD IN A MANNER THAT IS IN COMPLIANCE WITH THE REQUIRED PERFORMANCE FOR THAT ELEMENT.

FIRE DETECTORS :
 S/A DENOTED ON PLANS REFERS TO A OPTICAL SMOKE ALARMS FITTED WHERE SHOWN
 H/A DENOTED ON PLANS REFERS TO A HEAT ALARM FITTED IN KITCHEN AREA AS SHOWN ON PLANS.
 OPTICAL SMOKE ALARMS TO CONFORM TO BS EN 14604: 2005 AND HEAT ALARMS TO CONFORM TO BS 5446: PART 2: 2005.
 DETECTORS TO BE INTERLINKED & COMPLY WITH BS 5839 : PART 6 : 2004 AND BE FITTED WITHIN 3M OF APARTMENTS AND BE MIN 300mm FROM WALLS AND LIGHT FITTINGS. SMOKE ALARM TO BE FITTED BETWEEN 25mm AND 400mm BELOW CEILING LEVEL AND HEAT ALARMS BETWEEN 25mm AND 150mm BELOW CEILING LEVEL.
 SMOKE ALARMS SHOULD NOT BE FITTED DIRECTLY ABOVE HEATERS OR VENTILATORS THAT MAY DRAW DUST AND FINE PARTICLES INTO THE SMOKE ALARM.
 SMOKE & HEAT ALARMS TO BE MAINS OPERATED AND PERMANENTLY WIRED TO A CIRCUIT.
 ALARMS TO HAVE AN INDEPENDENT CIRCUIT AT THE MAIN DISTRIBUTION BOARD.
 NO OTHER ELECTRICAL EQUIPMENT TO BE CONNECTED TO THIS CIRCUIT.
 PRIMARY BATTERY STANDBY SUPPLY FOR ALARMS TO BE AT LEAST 72 HOURS.

DRAINAGE NOTES :
 PROPOSED DRAINAGE TO BE IN ACCORDANCE WITH BS EN 12056-1 :2000, BS EN 12056-2 :2000 & B.S EN 752-4 : 2013. ALL DRAINAGE TO COMPLY WITH THE SCOTTISH BUILDING STANDARDS AND BE TO THE SATISFACTION OF THE LOCAL AUTHORITY INSPECTOR.
 W.C. TO HAVE A 100mm dia PVC AS WASTE.
 WHB TO HAVE A 32mm dia ABS TRAP AND WASTE.
 SHOWER TO HAVE A 40mm dia ABS TRAP AND WASTE.
 SHOWER TRAP TO BE TOP ACCESSIBLE. SHOWER TO BE FITTED WITH AN ANTI-SCALD VALVE.
 PIPE WORK TO DRINKING WATER SUPPLY AT COLD TAP ON SINK TO BE JOINTED USING NON-LEAD SOLDER.
 ALL DRAINAGE PIPES TO BE SUPPORTED ALONG THEIR LENGTHS TO MANUFACTURERS INSTRUCTIONS, USING MANUFACTURERS CLIPS.
 ALL PIPE WORK TO BE ADEQUATELY EARTH BONDED.
 AAV TO BE ABOVE FLOOD LEVEL OF HIGHEST APPLIANCE AND ACCESSIBLE.
 AAV TO BE BOXED IN WITH ACCESS AND TO BE VENTILATED.
 AAV'S SHOULD BE INSTALLED IN ACCORDANCE WITH THE RECOMMENDATIONS IN BS EN 12380 : 2002, OR IN COMPLIANCE WITH THE CONDITIONS OF CERTIFICATE OF A NOTIFIED BODY.
 NEW WATER PIPE WORK TO BE INSULATED IN ACCORDANCE WITH THE GUIDANCE CONTAINED IN THE BRE REPORT REF 262: THERMAL INSULATION, AVOIDING RISKS (2002 EDITION), BS 5422 : 2001 AND BS 5422 : 2009.
 PROVIDE RODDING ACCESS AT ALL CHANGE OF DIRECTIONS AND END OF DRAINAGE RUNS.
 NEW SVP TO TERMINATE MIN. 900mm ABOVE OPENABLE WINDOWS.

WATER EFFICIENT FITTINGS
 W.C. AND WHB IN SHOWER ROOM TO HAVE WATER EFFICIENT FITTINGS.
 DUAL FLUSH W.C. TO HAVE AN AVERAGE VOLUME OF NOT MORE THAN 4.5 litres. SINGLE FLUSH W.C. TO HAVE A FLUSH VOLUME NOT MORE THAN 4.5 litres. WHB TAPS TO HAVE A FLOW RATE NOT EXCEEDING 6 LITRES PER MINUTE.

FIRE PROTECTION TO PIPES IN ATTIC SPACE :
 NEW DUCTS WITHIN ATTIC SPACE TO BE FIRE PROTECTED USING 25mm THICK PROMAT SUPALUX BOARDS.
 BOARDS TO BE FIXED USING M4 SCREWS AT 250mm CENTRES FIXED TO 30mm x 30mm x 0.8mm ANGLES ALL PER LITERATURE PROVIDED AND TO PROVIDE A MINIMUM OF 60 MINUTES FIRE RESISTANCE.

EXISTING AND PROPOSED OCCUPANT CAPACITY = 5 PERSONS.

NEW SHOWER ROOM
 NEW SHOWER ROOM TO BE FORMED WITHIN EXISTING BOXROOM.
 EXISTING DOOR PROVIDES A 775mm CLEAR WIDE OPENING.
 SANITARY FITTINGS TO BE FITTED TO CLIENTS SPECIFICATION AND PER NOTES PROVIDED.
 NEW WHB, W.C AND SHOWER TO BE INSTALLED WHERE SHOWN WITH DRAINS AS FOLLOWS :
 WHB TO HAVE A 32mm dia. WASTE AND TRAP.
 W.C. TO HAVE A 100mm dia PVC PIPE AS WASTE.
 SHOWER TO HAVE A 40mm dia ABS TRAP AND WASTE.
 SHOWER TRAP TO BE TOP ACCESSIBLE.
 SHOWER TO BE FITTED WITH AN ANTI SCALD VALVE.
 SHOWER WALLS TO BE IMPERVIOUS TO THE PASSAGE OF MOISTURE.
 LIGHT FITTINGS IN SHOWER ROOM TO BE CONSTRUCTED FROM OR SHROUDED IN INSULATING MATERIAL.
 LIGHT SWITCH TO BE OUT WITH ROOM AND FITTED AT A HEIGHT BETWEEN 900mm AND 1100mm ABOVE FINISHED FLOOR LEVEL.
 NEW CEILING MOUNTED MECHANICAL EXTRACT FAN TO BE FITTED WHERE SHOWN.
 NEW FAN TO BE A LO-CARBON CENTRA DMEV CONTINUOUSLY OPERATING EXTRACT FAN.
 FAN IS REQUIRED TO PROVIDE MIN. CONTINUOUS EXTRACT RATE OF 4 LITRES / SEC WITH 8 LITRES / SEC ON BOOST. FAN ACTUALLY PROVIDES 6 LITRES / SEC OR 9 LITRES / SEC ON BOOST.
 NEW FAN TO BE CONNECTED TO A NEW 100mm dia RIGID DUCT AND TAKEN UP THROUGH ROOF AND FITTED WITH WEATHER FLASHING AND STORM COWL AT TERMINATION.
 FAN TO BE FITTED WITH A CONDENSATE TRAP TO PROTECT FAN MECHANISM FROM CONDENSATION WITHIN DUCT.
 FAN TO BE FITTED WITH AN ISOLATOR SWITCH.
 DUCT FROM EXTRACT FAN TO BE FIRE PROTECTED WITHIN ATTIC SPACE PER NOTES PROVIDED.
 NEW RYTONS SUPER ACOUSTIC CONTROLLABLE LOOKRYT AIRCORE TRICKLE VENT TO BE FITTED AND DUCTED UP THROUGH ROOF. TRICKLE VENT PROVIDES 8,500mm² DUCT TO BE FITTED WITH FLASHING AND STORM COWL AND FIRE PROTECTED WITHIN ATTIC SPACE PER NOTES PROVIDED.

BEDROOM 4
 EXISTING DOORWAY BETWEEN BEDROOM 4 AND NEW SHOWER ROOM TO BE BUILT UP WITH TIMBER STUDS AT 600mm CENTRES WITH MIN. 25mm ROCKWOOL ACOUSTIC PARTITION SLAB (10kg/m²) TO ENHANCE ACOUSTIC PROPERTIES.
 PARTITIONS TO BE FINISHED BOTH SIDES USING 12.5mm GYPROC WALL BOARD 10 (10kg/m²) WITH SKIM COAT PLASTER.

- ELECTRICAL KEY**
- TWIN 13A SOCKET OUTLET
 - LOW ENERGY CEILING MOUNTED LIGHT POINT
 - RECESSED CEILING LIGHT POINT
 - SMOKE ALARM
 - HEAT ALARM FITTED IN KITCHEN
 - CARBON MONOXIDE DETECTOR
 - CARBON DIOXIDE DETECTOR

Project			
ALTER FLAT LAYOUT AT 30 (TF) WEST MAITLAND STREET EDINBURGH EH12 5DX			
REVISION : 08 / 07 / 2019			
A - NOTES ADDED TO REFLECT BUILDING CONTROL OFFICERS REPORT SHEET.			
Client			
MR. JAMES GRAHAM			
Date	Scale	Dwg.Num.	
JUNE '19	1 : 50	2475 / 01A	
Planning & Building Design Ltd. 24 West Nicolson Street Edinburgh EH8 9DA			
Tel. 0131 662 8430 Fax. 0131 662 8431			