

Project 2

FP50

TOTAL AREA:105.19 m² • LIVING AREA:90.11 m² • FLOORS:2 • ROOMS:5

▼ Ground Floor

TOTAL AREA:57.83 m² • LIVING AREA:42.75 m² • ROOMS:2

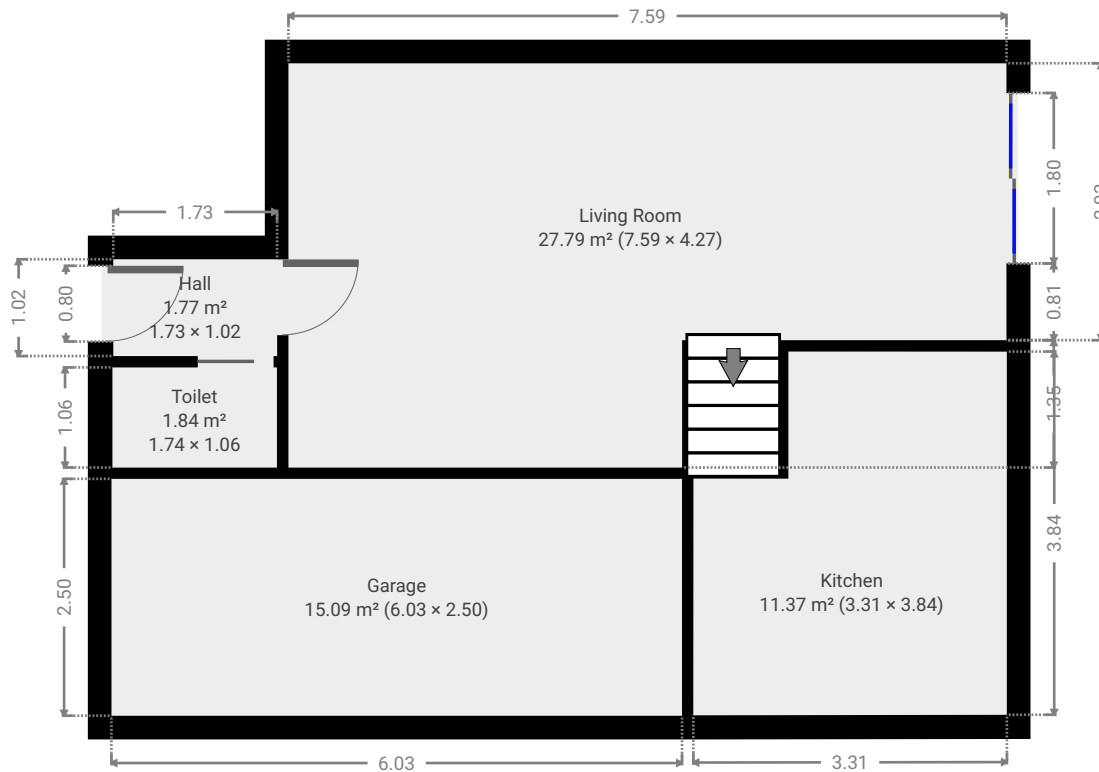

▼ 1st Floor

TOTAL AREA:47.36 m² • LIVING AREA:47.36 m² • ROOMS:3

