

Project 4

SUBMITTED BY

lucy.kosicka@onlineplc.co.uk

CREATED ON

2022-01-11

DETAILS

Total area: 35.35 m²
 Living area: 35.35 m²
 Floors: 1
 Rooms: 3

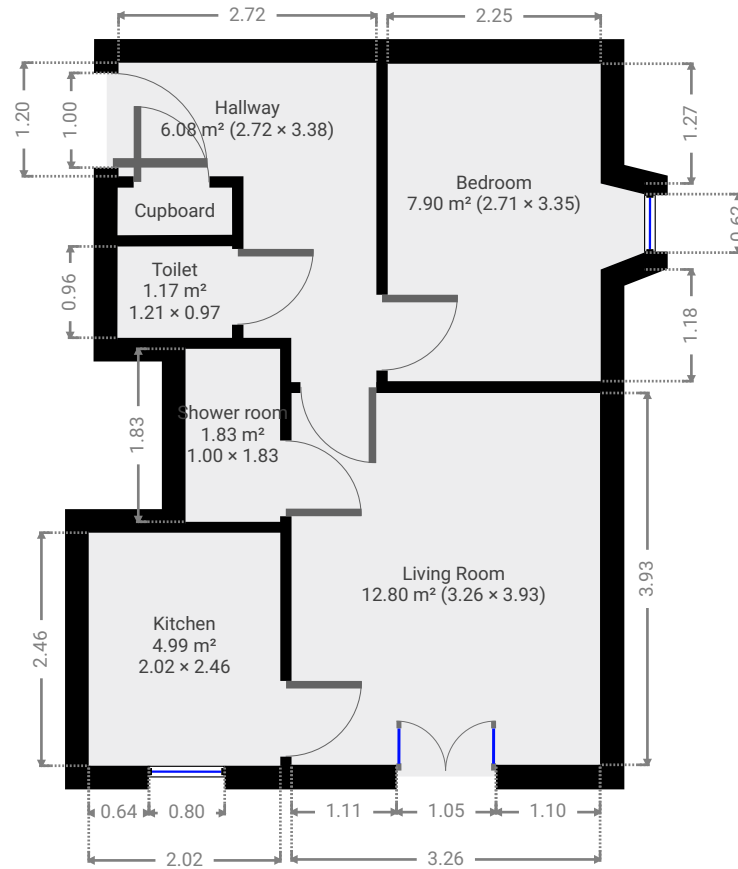

THIS FLOORPLAN IS PROVIDED WITHOUT WARRANTY OF ANY KIND. SENSOPIA DISCLAIMS ANY WARRANTY INCLUDING, WITHOUT LIMITATION, SATISFACTORY QUALITY OR ACCURACY OF DIMENSIONS.

