

DWANG/JOIST UNDER ALL NEW PARTITION LINES TAKING CARE TO MAINTAIN EXISTING DEAFENING IN FLOOR ZONE

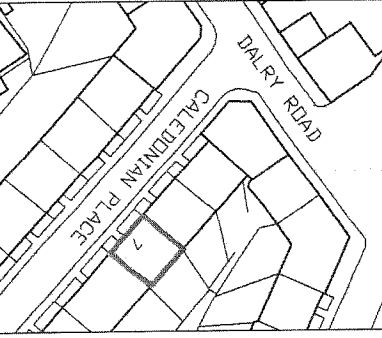

SCALE 1:1250
DENOTES EXTENT OF BOUNDARY

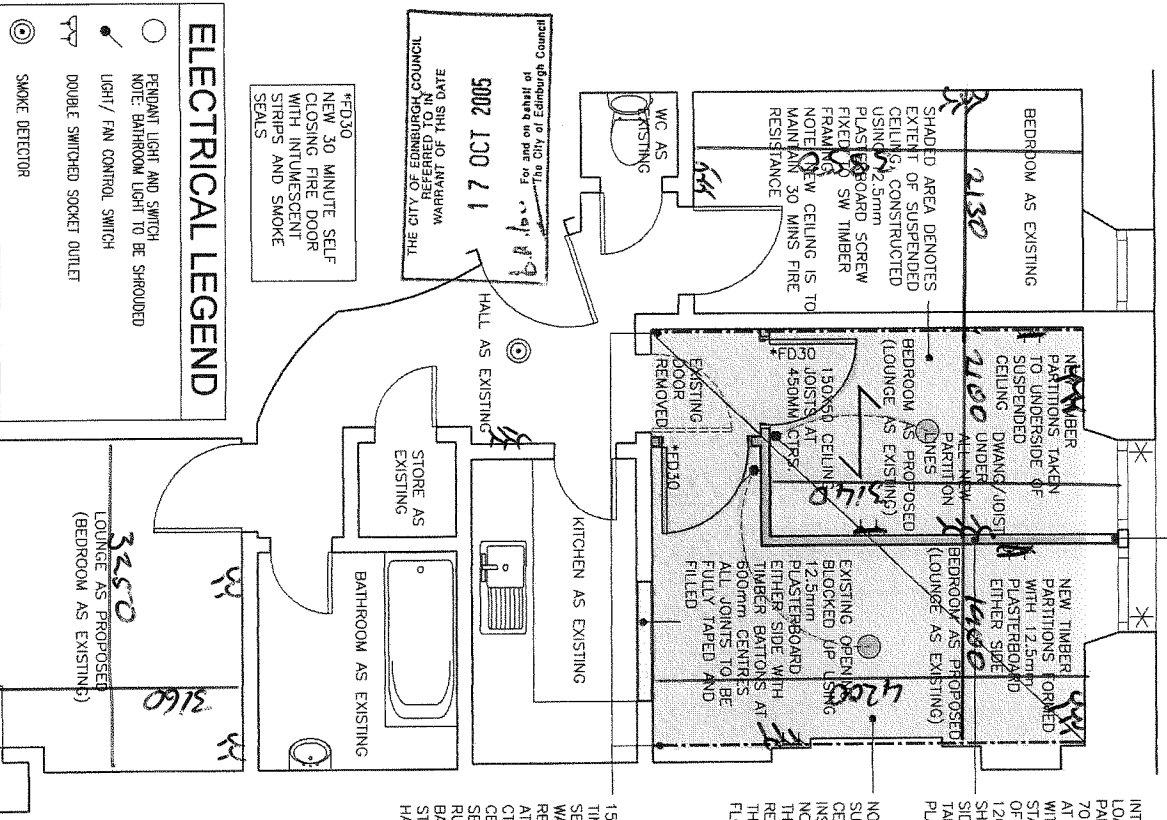
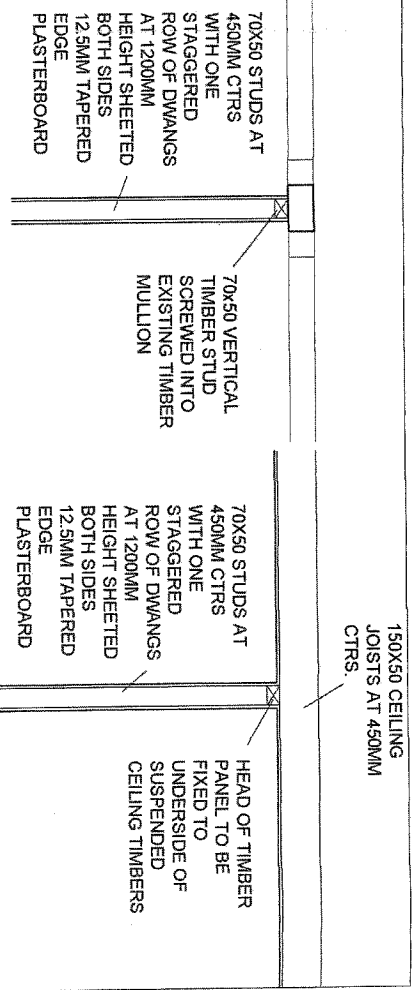

DETAIL OF JUNCTION OF NEW PARTITION AND EXISTING WINDOW (1:20)

DETAIL THROUGH NEW PARTITION AND CEILING RELATIONSHIP (1:20)

WARRANT NOTES

ALL MATERIALS TO BE IN ACCORDANCE WITH THE RELEVANT BRITISH STANDARDS.

SMOKE DETECTORS FITTED IN ACCORDANCE WITH BS:5446:PART1:1990. MAINS OPERATED SMOKE DETECTOR WITH 72 HOUR STANDBY SUPPLY AND AUDIBLE WARNING THAT MAINS SUPPLY IS OFF WITH CAPACITY FOR WARNING OF SMOKE FOR A FURTHER 4 MINUTES. AUDIBLE WARNING TO BE GIVEN EVERY MINUTE WHEN STANDBY SUPPLY FALLS BELOW THAT REQUIRED TO SATISFY NECESSARY DURATION. ALARM TO BE CEILING MOUNTED, AT LEAST 300mm FROM ANY WALL OR LIGHT FITTING AND LOCATED NOT MORE THAN 7m FROM DOOR TO LIVING ROOM OR KITCHEN AND NOT MORE THAN 2m FROM DOOR TO A ROOM INTENDED TO BE USED AS SLEEPING ACCOMMODATION. TO BE MEASURED HORIZONTALLY.

ELECTRICAL INSTALLATION TO COMPLY WITH RELEVANT REQUIREMENTS OF BS 7671:2001.

*** DENOTES REQUIREMENTS OF EXISTING SASH AND CASE WINDOW**

NEW 8000mm² TRICKLE VENTILATOR TO BE FITTED

WINDOW TO HAVE GLAZED AREA NO LESS THAN 7% OF THE FLOOR AREA. WORST CASE - 7%. FLOOR AREA = 9.31m². AREA OF GLAZING = 1.12m². 1.12/9.31 = 12%. WINDOW TO HAVE OPENABLE AREA OF NO LESS THAN 7% OF THE FLOOR AREA. WORST CASE - 7%. FLOOR AREA = 9.31m². OPENABLE AREA = 0.56m². 0.56/9.31 = 6%. WINDOW TO HAVE OPENABLE AREA OF MIN 0.33m² AND MIN DIMENSIONS OF 450x450mm.

EXISTING GILL HEIGHT TO BE NO MORE THAN 1100mm FROM FFL TO ALLOW EASE OF ESCAPE IN CASE OF FIRE

Rev B. 07.10.05. DRAWING AMENDED IN ACCORDANCE WITH TELEPHONE CONVERSATION 06.10.05

Rev A. 22.09.05. DRAWING AMENDED IN ACCORDANCE WITH WARRANT REPORT

WE CERTIFY THAT THIS IS A TRUE COPY OF ONE OF THE DRAWINGS REFERRED TO IN THE DRAWING WARRANT APPLICATION

DATED 26/09/05
SIGNED [Signature]

FOR EMA ARCHITECTURE + DESIGN

ema
ARCHITECTURE + DESIGN

Geoffrey Burns
FLAT 11
7(F) CALEDONIAN PLACE, EDIN
EDINBURGH, SCOTLAND

PROPOSED PLAN
BUILDING WARRANT DRAWING

| | |
|----------|---|
| DATE | DESCRIPTION |
| 04.08.05 | ISSUED FOR PERMIT APPLICATION |
| 07.10.05 | AMENDED IN ACCORDANCE WITH WARRANT REPORT |
| 06.10.05 | AMENDED IN ACCORDANCE WITH WARRANT REPORT |

04800 81(00)001 B

CHARTERED ARCHITECTS
Edinburgh City Centre
F. 0131 488 5555
E. info@ema-architects.co.uk

ELECTRICAL LEGEND

- PERMANENT LIGHT AND SWITCH
NOTE: BATHROOM LIGHT TO BE SHROUDED LIGHT / FAN CONTROL SWITCH
- ⌚ DOUBLE SWITCHED SOCKET OUTLET
- ⊙ SMOKE DETECTOR

*FD30
NEW 30 MINUTE SELF CLOSING FIRE DOOR WITH INTUWESCENT STRIPS AND SMOKE SEALS

5002 100 7 1
For and on behalf of
The City of Edinburgh Council
WARRANT OF THIS DATE REFERRED TO IN 2010

INTERNAL NON LOAD BEARING PARTITIONS
70X50 STUDS AT 450MM CTRS WITH ONE STAGGERED ROW OF DWANGS AT 1200MM HEIGHT SHEETED BOTH SIDES 12.5MM TAPERED EDGE PLASTERBOARD

NEW TIMBER PARTITIONS FORMED WITH 12.5mm PLASTERBOARD EITHER SIDE

EXISTING OPENING BLOCKED UP USING 12.5mm PLASTERBOARD EITHER SIDE WITH TIMBER BATTONS AT 500mm CENTRES ALL JOINTS TO BE FULLY TAPED AND FILLED

EXISTING CEILING SECURED TO WALL WITH TM112 RESIN ACHOR AT 600MM CTRS.

CEILING JOISTS SECURED TO RUNNER WITH BAT SPEEDY STANDARD JOIST HANGERS

150X50MM TIMBER RUNNER SECURED TO WALL WITH TM112 RESIN ACHOR AT 600MM CTRS.

CEILING JOISTS SECURED TO RUNNER WITH BAT SPEEDY STANDARD JOIST HANGERS

NOTE:
SUSPENDED CEILING INSTALLATION IS NOT TO IMPAIR THE FIRE RESISTANCE OF THE SEPARATING FLOOR ABOVE

70X50 STUDS AT 450MM CTRS WITH ONE STAGGERED ROW OF DWANGS AT 1200MM HEIGHT SHEETED BOTH SIDES 12.5MM TAPERED EDGE PLASTERBOARD

70X50 VERTICAL TIMBER STUD SREWED INTO EXISTING TIMBER MULLION

70X50 STUDS AT 450MM CTRS WITH ONE STAGGERED ROW OF DWANGS AT 1200MM HEIGHT SHEETED BOTH SIDES 12.5MM TAPERED EDGE PLASTERBOARD

HEAD OF TIMBER PANEL TO BE FIXED TO UNDERSIDE OF SUSPENDED CEILING TIMBERS